

KEY MAP
SCALE: N.T.S.

STREET TREES	BOTANICAL NAME	COMMON NAME
AG	ACER RUBRUM 'OCTOBER GLORY'	RED MAPLE
AS	ACER SACCHARINUM	SUGAR MAPLE
AF	AESOLUS X CAMELIA 'FORT MYNARY'	RED HORSECHESNUT
AA	AMELANCHIER ARBOREA 'REDHILL'	SERVICEBERRY
CV	CHONANTHUS VIRGINICUS	WHITE FRINGETREE
IB	GLEDITSIA TRIACANTHOS 'INERMIS'	THORNLESS HONEY LOCUST
ME	MALUS 'SUNSET TINE'	ORANGE
YG	TILIA CORDATA 'GREENSPICE'	LITTLE LEAF LINDEN

BUFFER & OPEN SPACE	BOTANICAL NAME	COMMON NAME
AR	ACER RUBRUM	RED MAPLE
NS	NYSSA SILVATICA	SOUR GLUM
QP	QUERCUS PAUCIFLORA	PIN OAK

EVERGREEN TREES	BOTANICAL NAME	COMMON NAME
JE	JUNIPERUS VIRGINIANA	EASTERN RED CEDAR
PG	PICEA GLAUCA	WHITE SPRUCE
PP	PICEA PLUMBERGII	COLORADO SPRUCE
PS	PINUS STROBILUS	WHITE PINE

ORNAMENTAL TREES	BOTANICAL NAME	COMMON NAME
AC	AMELANCHIER CANADENSIS	SERVICEBERRY
BC	BETULA NIGRA 'GLAY'	RIVER BIRCH
CK	CORNUS KOUSA	KOUSA DOGWOOD
M/M	MAGNOLIA STELLATA	STAR MAGNOLIA
DA	DYWIDENRON ARBOREA	SOURWOOD TREE

SHRUBS	BOTANICAL NAME	COMMON NAME
CA	CLETHRA ALNIFOLIA	SUMMERSWEET CLETHRA
CP	CORNUS RACEVOSIA	GRAY DOGWOOD
HV	HIBISCUS VIRGINIANUS	WITCH HAZEL
IG	ILEX GLABRA	WINTERBERRY HOLLY
IW	ILEX VERTICILLATA 'WINTER RED'	WINTERBERRY
NP	NANICA PENNSYLVANICA	NORTHERN SABBERRY
PL	PRUNELLA ROXBORGHII 'SICILY VARIETALIS'	CHERRY PLUM
VL	VIBURNUM LENTAGO	NANANBERRY
VD	VIBURNUM DENTATUM	ARROWWOOD VIBURNUM

● STREET LIGHT

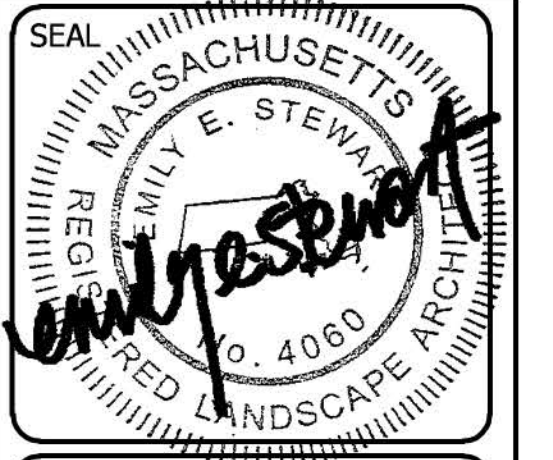

ESE CONSULTANTS
ENGINEERING • PLANNING • SURVEYING • ENVIRONMENTAL

ESE Consultants, Inc.
250 Gibraltar Road • Suite 2E • Horsham, PA 19044
T: 215-914-2050

PLAN REVISIONS

REV.	DATE	DESCRIPTION

PROJECT NAME:
SEASIDE AT SCITUATE

PROJECT LOCATION:
TOWN OF SCITUATE
PLYMOUTH COUNTY
MASSACHUSETTS

SHEET TITLE:
LANDSCAPE PLAN

DATE: 2017.04.20	SCALE: 1"=40'
DESIGN: EES	DRAWN: EES
JOB NO.: 3599	FILE NAME: 3599-S-LAND
REF: SD09.01	
SHEET NO.: 1	OF 10

NOTES:
1. FOR LANDSCAPE PURPOSES ONLY. FOR SITE PLAN AND ENGINEERING INFORMATION REFER TO PLANS PREPARED BY STANTEC.
2. SEE SHEETS SD09.06-10 FOR ADDITIONAL LANDSCAPE DETAILS AND PLANTING SCHEDULE.

GRAPHIC SCALE
0 20 40 80 160 FEET
1 inch = 40 ft.

Apr 20, 2017 - 4:43 pm - H:\Projects\Massachusetts\3599 - Seaside at Scituate (February 16) (User: Umang\3599-1-LAND.dwg - sheet1)

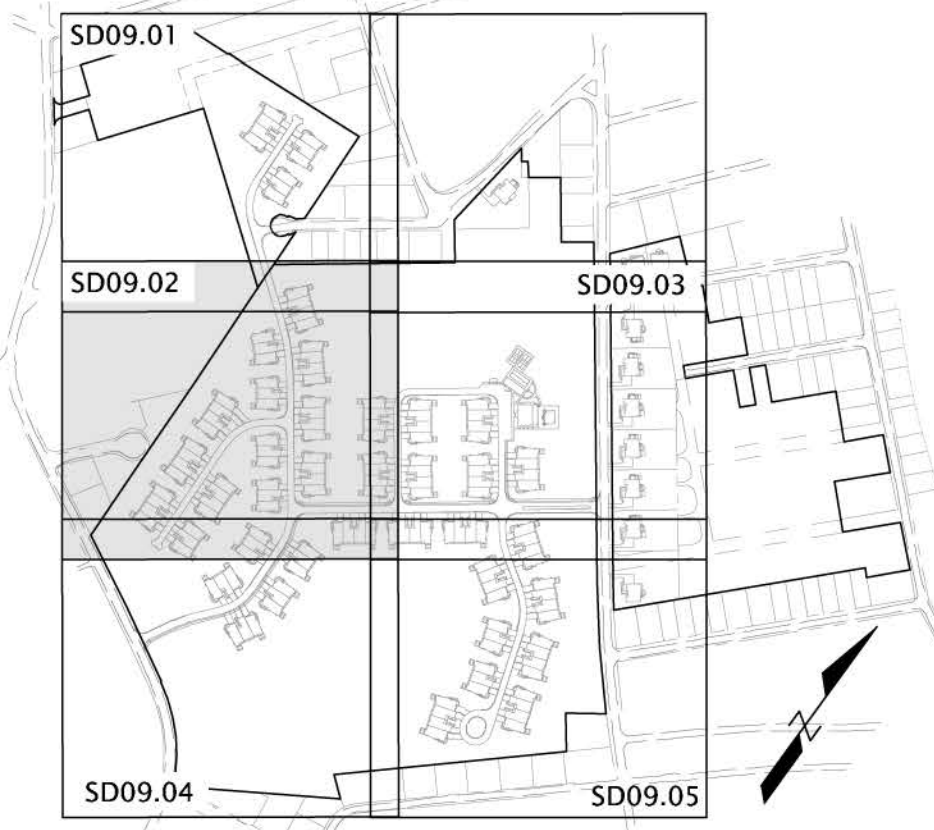

KEY MAP
SCALE: N.T.S.

STREET TREES	BOTANICAL NAME	COMMON NAME
AS	ACER RUBRUM 'OCTOBER GLORY'	RED MAPLE
AS	ACER SACCHARINUM	SUGAR MAPLE
AF	AESOLUS X CARMELIA 'FORT MYNARY'	RED HORSE CESTRUM
AA	AMELANCHIER ALBOVARIA 'WINTER HELL'	SERVICEBERRY
CV	CHONANTHUS VIRGINICUS	WHITE FRINGETREE
GB	GLEDITSIA TRIACANTHOS 'INERMIS'	THORNLESS HONEY LOCUST
MS	MALUS 'SUGAR TUNE'	ORNA APPLE
TG	TILIA CORDATA 'GREENSPICE'	LITTLE LEAF LINDEN

BUFFER & OPEN SPACE	BOTANICAL NAME	COMMON NAME
AR	ACER RUBRUM	RED MAPLE
NS	NYSSA SILVATICA	SOUL GLAM
QP	QUERCUS PAUCIFLORA	PIN OAK

EVERGREEN TREES	BOTANICAL NAME	COMMON NAME
JE	JUNIPERUS VIRGINIANA	EASTERN RED CEDAR
PP	PICEA PLUMBENS	WHITE SPRUCE
PS	PINUS STROBILUS	COLORADO SPRUCE

ORNAMENTAL TREES	BOTANICAL NAME	COMMON NAME
AC	AMELANCHIER CANADENSIS	SERVICEBERRY
BC	BETULA NIGRA 'GLORY'	RIVER BIRCH
CK	CORNUS KOLSA	KOUSA DOGWOOD
MM	MARGOLIA STELLATA	STAR MARGOLIA
DA	DYWIDENRON ARBOREA	SOURWOOD TREE

SHRUBS	BOTANICAL NAME	COMMON NAME
CA	CLETHRA ALNIFOLIA	SUMMERSWEET CLETHRA
CP	CORNUS RACEVOSA	GRAY DOGWOOD
HV	HIBERNUS VIRGINIANA	WITCH HAZEL
IG	ILEX GLABRA	INHERBERRY HOLLY
IW	ILEX VERTICILLATA 'WINTER RED'	WINTERBERRY
NP	NANICA PENNSYLVANICA	NORTHERN SAWBERRY
PL	PRUNELLA SPICATA 'SARAWAKENSIS'	CHERRY PLUM
VL	VIBURNUM LENTAGO	NANANBERRY
VD	VIBURNUM DENTATUM	ARROWWOOD VIBURNUM

● STREET LIGHT

NOTES:
1. FOR LANDSCAPE PURPOSES ONLY. FOR SITE PLAN AND ENGINEERING INFORMATION REFER TO PLANS PREPARED BY STANTEC.
2. SEE SHEETS SD09.06-10 FOR ADDITIONAL LANDSCAPE DETAILS AND PLANTING SCHEDULE.

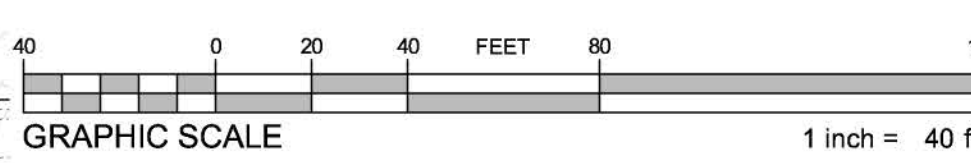

ESE CONSULTANTS
ENGINEERING • PLANNING • SURVEYING • ENVIRONMENTAL

ESE Consultants, Inc.
250 Gibraltar Road • Suite 2E • Horsham, PA 19044
T: 215-914-2050

PLAN REVISIONS

REV.	DATE	DESCRIPTION

PROJECT NAME:

SEASIDE AT SCITUATE

PROJECT LOCATION:
TOWN OF SCITUATE
PLYMOUTH COUNTY
MASSACHUSETTS

SHEET TITLE:

LANDSCAPE PLAN

DATE: 2017.04.20	SCALE: 1"=40'
DESIGN: EES	DRAWN: EES
JOB NO.:# 3599	FILE NAME: 3599-S-LAND
REF.: SD09.02	
SHEET NO.:# 	2 OF 10

Apr 20, 2017 - 4:44 pm - H:\Projects\Massachusetts\3599 Seaside at Scituate (04/20/17)\DWG\03090-5-LAND.dwg - ees

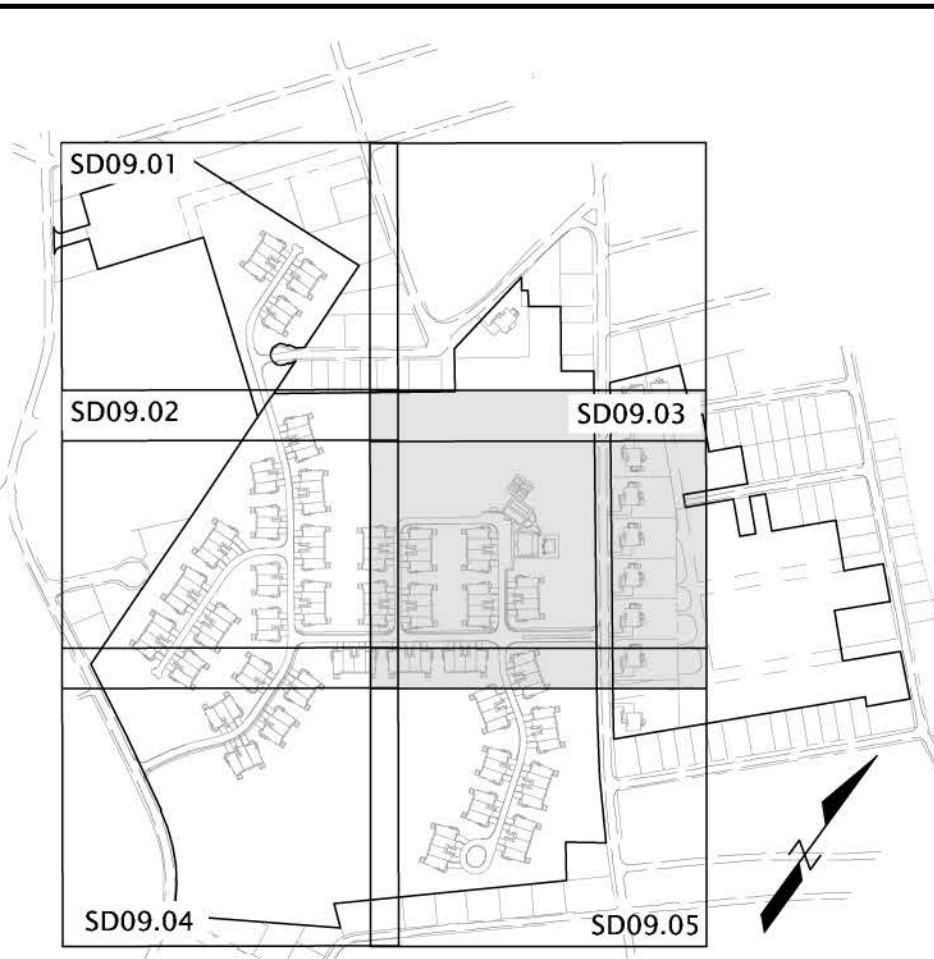

KEY MAP
SCALE: N.T.S.

STREET TREES	BOTANICAL NAME	COMMON NAME
AG	ACER RUBRUM 'OCTOBER GLORY'	RED MAPLE
AS	ACER SACCHARINUM	SUGAR MAPLE
AF	AESOLUS X CAMELIA 'FORT MYNARY'	RED HORSESHOE TREE
AA	ANEMONE FRANSERENSIS 'RED HILL'	SERVICE BERRY
CV	CHONANTHUS VIRGINICUS	WHITE FRINGEE TREE
IB	GLEDITSIA TRICANTHOS 'INERMIS'	THORNLESS HONEY LOCUST
ME	MALUS 'SUNSET TINE'	ORCHARD APPLE
TG	TILIA CORDATA 'GREEN SPICE'	LITTLE LEAF LINDEN

BUFFER & OPEN SPACE	BOTANICAL NAME	COMMON NAME
AR	ACER RUBRUM	RED MAPLE
NS	NYSSA SILVATICA	SOUR GUM
QP	QUERCUS PAUCIFLORA	PIN OAK

EVERGREEN TREES	BOTANICAL NAME	COMMON NAME
JE	JUNIPERUS VIRGINIANA	EASTERN RED CEDAR
PP	PIROSA PLUNIFENS	COLORADO SPRUCE
PS	PINUS STROBILUS	WHITE PINE

ORNAMENTAL TREES	BOTANICAL NAME	COMMON NAME
AC	AMELANCHIER CANADENSIS	SERVICE BERRY
BC	BETULA NIGRA 'GLORY'	RIVER BIRCH
CK	CORNUS KOLSA	KOUSA DOGWOOD
MM	MARGONIA STELLATA	STAR MARGONIA
DA	DAVIDENORON ARBORESCA	SOURWOOD TREE

SHRUBS	BOTANICAL NAME	COMMON NAME
CA	CLETHRA ALNIFOLIA	SUMMERSWEET CLETHRA
CP	CORNUS RACEMOSA	GRAY DOGWOOD
HV	HIBISCUS VIRGINIANUS	WITCH HAZEL
IS	ILEX GLABRA	INBERRY HOLLY
IW	ILEX VERTICILLATA 'WINTER RED'	WINTER BERRY
NP	NANICA PENNSYLVANICA	NORTHERN SAWBERRY
PL	PRUNELLA SPICATA 'SARAWANENSIS'	CHERRY PLUM
VL	VIBURNUM LENTAGO	NANAN BERRY
VD	VIBURNUM DENTATUM	ARBORWOOD VIBURNUM

● STREET LIGHT



ESE CONSULTANTS
ENGINEERING • PLANNING • SURVEYING • ENVIRONMENTAL

ESE Consultants, Inc.
250 Gibraltar Road • Suite 2E • Horsham, PA 19044
T: 215-914-2050

PLAN REVISIONS

REV.	DATE	DESCRIPTION

PROJECT NAME:
SEASIDE AT SCITUATE

PROJECT LOCATION:
TOWN OF SCITUATE
PLYMOUTH COUNTY
MASSACHUSETTS

SHEET TITLE:
LANDSCAPE PLAN

DATE: 2017.04.20	SCALE: 1"=40'
DESIGN: EES	DRAWN: EES
JOB NO.: 3599	FILE NAME: 3599-S-LAND
REF.: SD09.03	
SHEET NO.: 	3 OF 10

NOTES:
1. FOR LANDSCAPE PURPOSES ONLY. FOR SITE PLAN AND ENGINEERING INFORMATION REFER TO PLANS PREPARED BY STANTEC.
2. SEE SHEETS SD09.06-10 FOR ADDITIONAL LANDSCAPE DETAILS AND PLANTING SCHEDULE.

GRAPHIC SCALE
1 inch = 40 ft.

Apr 20, 2017 - 5:00 pm - 14_VillageMassachusetts_3599_Sheet 3 - 3599_SitePlan_Landscape.dwg

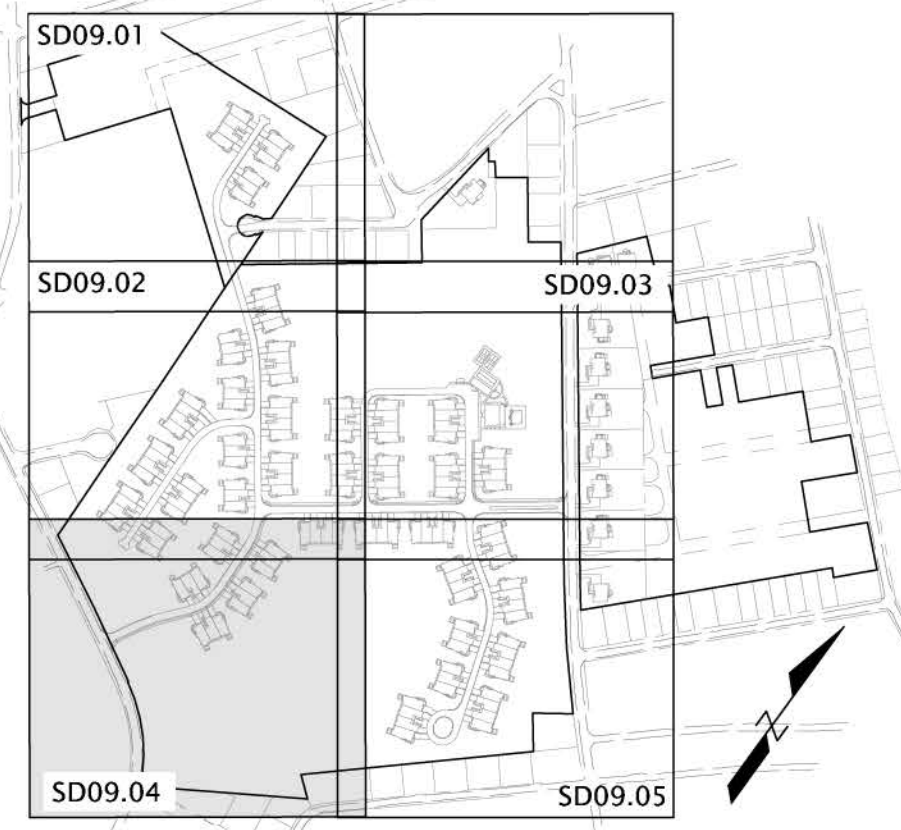

KEY MAP
SCALE: N.T.S.

STREET TREES	BOTANICAL NAME	COMMON NAME
AS	ACER RUBRUM 'OCTOBER GLORY'	RED MAPLE
AS	ACER SACCHARINUM	SUGAR MAPLE
AF	AESOLUS X CAMPENIA 'FORT MYNARY'	RED HORSE CHESTNUT
AA	AMELANCHIER ARBOREA 'REDIN HILL'	SERVICEBERRY
CV	CHONANTHUS VIRGINICUS	WHITE FRINGETREE
CB	GLEDITSIA TRIACANTHOS 'INERMIS'	THORNLESS HONEY LOCUST
ME	MALUS 'SUNSET TIME'	ORANGE APPLE
TG	TILIA CORDATA 'GREENSPICE'	LITTLE LEAF LINDEN

BUFFER & OPEN SPACE	BOTANICAL NAME	COMMON NAME
AR	ACER RUBRUM	RED MAPLE
NS	NYSSA SILVATICA	SOUR GUM
QP	QUERCUS PAUCIFLORA	PINOAK

EVERGREEN TREES	BOTANICAL NAME	COMMON NAME
JE	JUNIPERUS VIRGINIANA	EASTERN RED CEDAR
PS	PICEA GLAUCA	WHITE SPRUCE
PP	PICEA PLUMBERGII	COLORADO SPRUCE
PS	PINUS STROBUS	WHITE PINE

ORNAMENTAL TREES	BOTANICAL NAME	COMMON NAME
AC	AMELANCHIER CANADENSIS	SERVICEBERRY
BC	BETULA NIGRA 'GLAY'	RIVER BIRCH
CK	CORNUS KOLSA	KOUSA DOGWOOD
M/M	MAGNOLIA STELLATA	STAR MAGNOLIA
DA	DYWIDENDRON ARBOREUM	SOURWOOD TREE

SHRUBS	BOTANICAL NAME	COMMON NAME
CA	CLETHRA ALNIFOLIA	SUMMERSWEET CLETHRA
CP	CORNUS RACEVOSIA	GRAY DOGWOOD
HW	HAMAMULUS VIRGINIANA	WITCH HAZEL
IS	ILEX GLABRA	INBERRY HOLLY
IW	ILEX VERTICILLATA 'WINTER RED'	WINTERBERRY
NP	NANICA PENNSYLVANICA	NORTHERN SAWBERRY
PL	PRINELABRUS CORNUTUS 'SICAMORUS'	DEERPLUM
VL	VIBURNUM LANCEOLATUM	NANANBERRY
VD	VIBURNUM IDENTATUM	ARROWWOOD VIBURNUM

● STREET LIGHT



ESE CONSULTANTS
ENGINEERING • PLANNING • SURVEYING • ENVIRONMENTAL

ESE Consultants, Inc.
250 Gibraltar Road • Suite 2E • Horsham, PA 19044
T: 215-914-2050

PLAN REVISIONS

REV.	DATE	DESCRIPTION

PROJECT NAME:
SEASIDE AT SCITUATE

PROJECT LOCATION:
TOWN OF SCITUATE
PLYMOUTH COUNTY
MASSACHUSETTS

SHEET TITLE:
LANDSCAPE PLAN

DATE: 2017.04.20	SCALE: 1"=40'
DESIGN: EES	DRAWN: EES
JOB NO.: 3599	FILE NAME: 3599-S-LAND
REF: SD09.04	SHEET NO.: 4 OF 10

NOTES:

- FOR LANDSCAPE PURPOSES ONLY. FOR SITE PLAN AND ENGINEERING INFORMATION REFER TO DRAWINGS PREPARED BY STANTEC.
- SEE SHEETS SD09.01, SD09.02, SD09.03, SD09.04, SD09.05 FOR LANDSCAPE DETAILS AND SCHEDULE.

GRAPHIC SCALE: 1 inch = 40 ft.

Apr 20, 2017 - 5:07 pm - N:\Projects\Massachusetts\3599 - Seaside at Scituate - (Primary) RD\Drawings\DWG\3599-S-LAND.dwg - sheet1

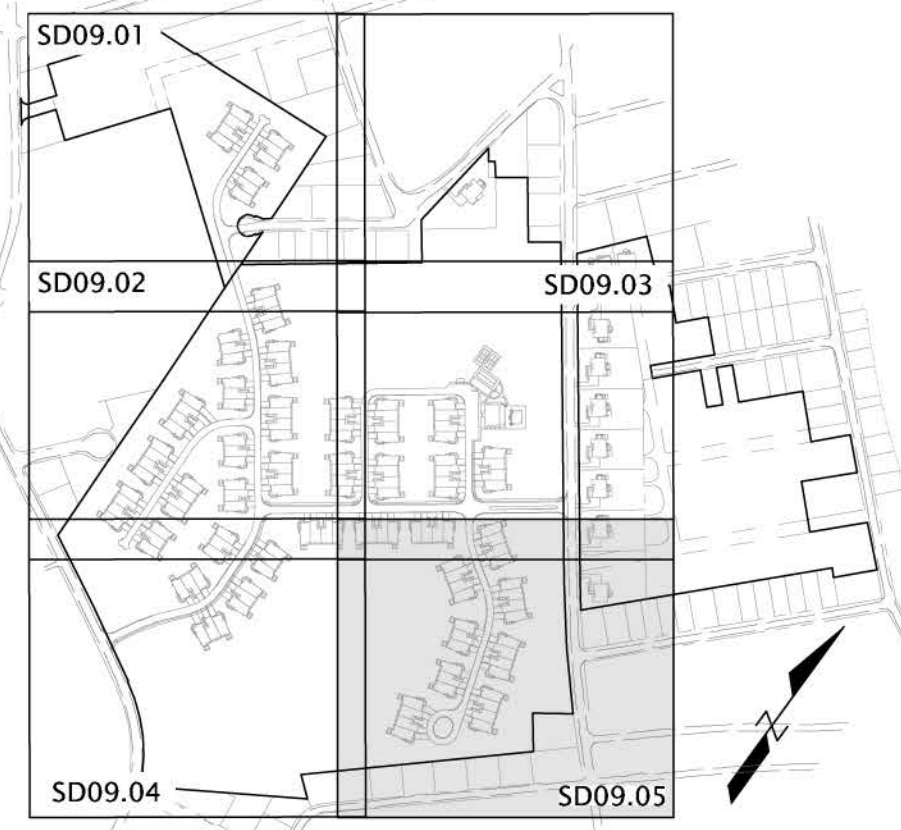

STREET TREES	BOTANICAL NAME	COMMON NAME
AG	ACER RUBRUM 'OCTOBER GLORY'	RED MAPLE
AS	ACER SACCHARINUM	SUGAR MAPLE
AF	AESOLUS X CAMELIA 'FORT MYNARY'	RED HORSESHOE ELLIPT
AA	AMELANCHIER ARBOREA 'NORDEN HILL'	SERVICEBERRY
CV	CHONANTHUS VIRGINICUS	WHITE FRINGETREE
CB	GLEDITSIA TRIACANTHOS 'INERMIS'	THORNLESS HONEY LOCUST
ME	MALUS 'SUNSHINE' M'	ORCHARD APPLE
YG	TILIA CORDATA 'GREENSPICE'	LITTLE LEAF LINDEN

BUFFER & OPEN SPACE	BOTANICAL NAME	COMMON NAME	
CANOPY TREES	AR	ACER RUBRUM	RED MAPLE
	NS	NYSSA SILVATICA	SOUR GUM
	QP	QUERCUS PAUCIFLORA	PINK OAK
EVERGREEN TREES	JE	JUNIPERUS VIRGINIANA	EASTERN RED CEDAR
	PS	PICEA GLAUCA	WHITE SPRUCE
	PS	PINUS STROBILUS	COLORADO SPRUCE
ORNAMENTAL TREES	AC	AMELANCHIER CANADENSIS	SERVICEBERRY
	BC	BETULA NIGRA 'GLAY'	RIVER BIRCH
	CR	CORNUS KOUSA	KOUSA DOGWOOD
SHRUBS	CA	CLETHRA ALNIFOLIA	SUMMERSWEET CLETHRA
	CR	CORNUS RACEMOSA	GRAY DOGWOOD
	HV	HAMAMELIS VIRGINIANA	WITCH HAZEL
IS	ILEX GLABRA	INBERRY HOLLY	
IW	ILEX VERTICILLATA 'WINTER RED'	WINTERBERRY	
NP	NYRICA PENNSYLVANICA	NORTHERN SAWBERRY	
PL	PRUNELLA SP. 'SUNSHINE'	CHERRY PLUM	
VL	VIBURNUM LANTANA	NANANBERRY	
VD	VIBURNUM DENTATUM	AWBERRY VIBURNUM	



ESE CONSULTANTS
 ENGINEERING • PLANNING • SURVEYING • ENVIRONMENTAL

ESE Consultants, Inc.
 250 Gibraltar Road • Suite 2E • Horsham, PA 19044
 T: 215-914-2050

PLAN REVISIONS

REV.	DATE	DESCRIPTION

PROJECT NAME:
SEASIDE AT SCITUATE

PROJECT LOCATION:
 TOWN OF SCITUATE
 PLYMOUTH COUNTY
 MASSACHUSETTS

SHEET TITLE:
LANDSCAPE PLAN

DATE: 2017.04.20
 DESIGN: EES
 JOB NO.: 3599
 REF: SD09.05

SCALE: 1"=40'
 DRAWN: EES
 FILE NAME: 3599-S-LAND
 SHEET NO.: 5 OF 10

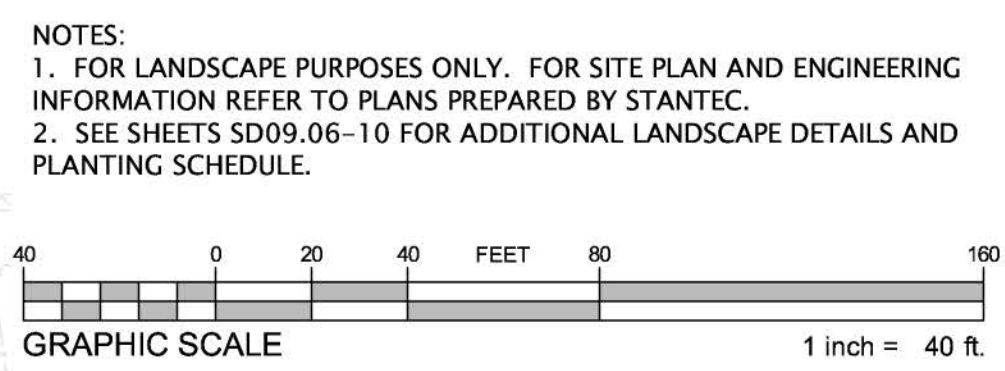

Apr 20, 2017 - 4:44 pm - W:\Projects\Massachusetts\3599 Seaside at Scituate (04/20/17)\DWG\3599-S-LAND.dwg - sheet

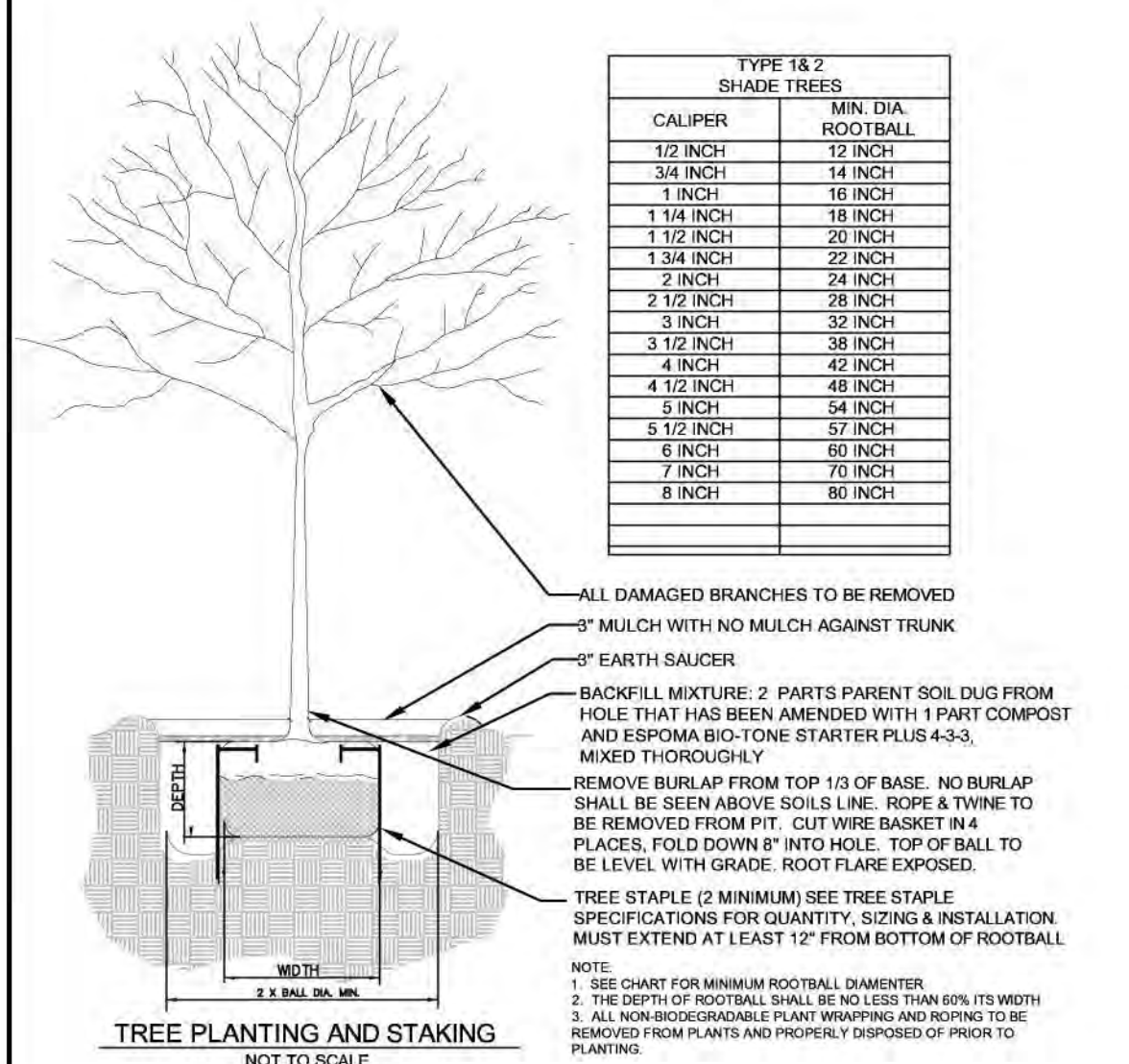

TYPE 1 & 2 SHADE TREES	MIN. DIA. ROOTBALL
1 1/2 INCH	12 INCH
2 INCH	14 INCH
2 1/2 INCH	16 INCH
3 INCH	18 INCH
3 1/2 INCH	20 INCH
4 INCH	22 INCH
4 1/2 INCH	24 INCH
5 INCH	26 INCH
5 1/2 INCH	28 INCH
6 INCH	30 INCH
6 1/2 INCH	32 INCH
7 INCH	34 INCH
7 1/2 INCH	36 INCH
8 INCH	38 INCH

TREE PLANTING AND STAKING NOT TO SCALE

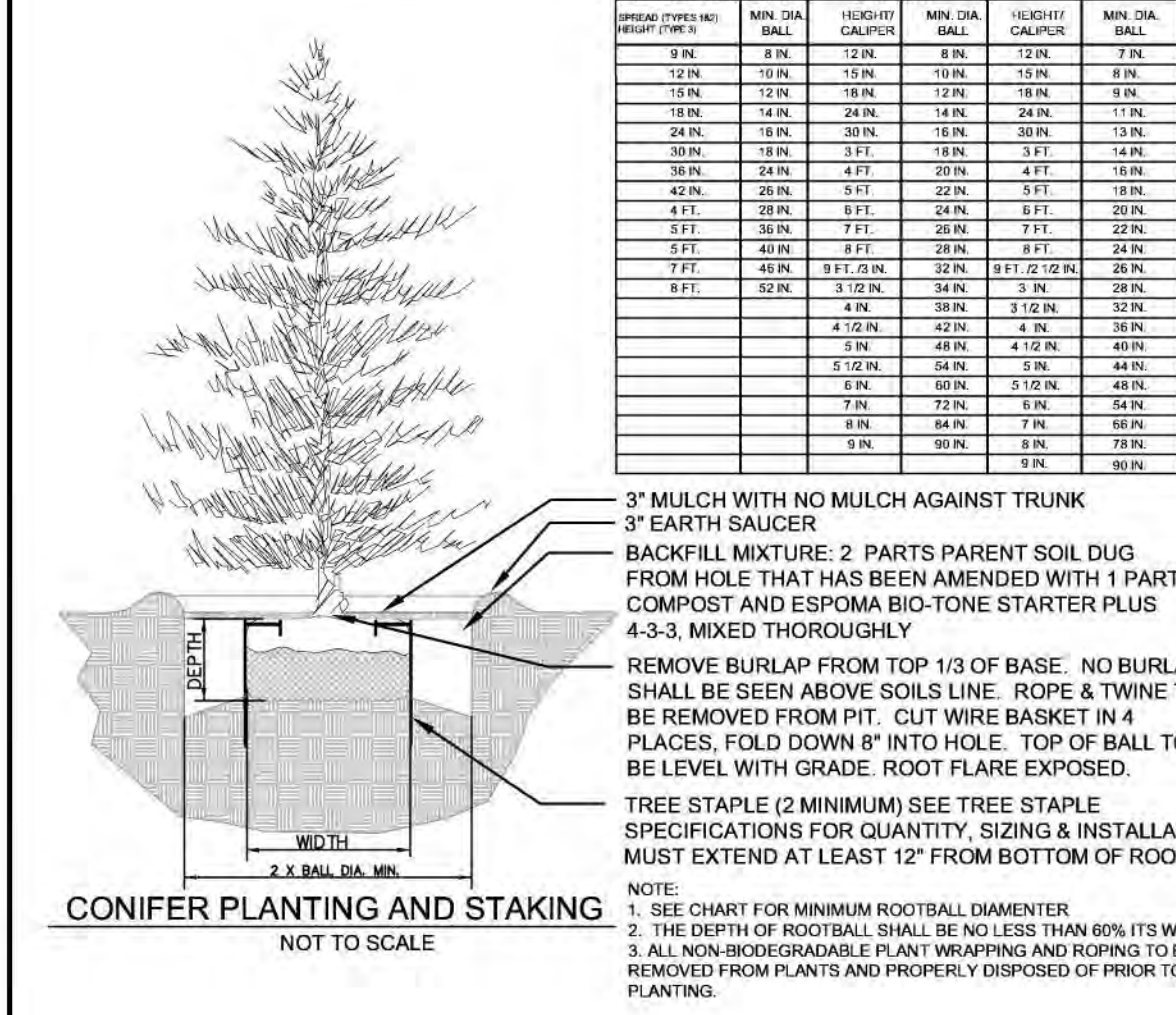

TYPE 1 & 2A SPREADING, BROAD-PYRAMIDAL, BROAD-UPRIGHT	TYPE 4&5 PYRAMIDAL, BROAD-UPRIGHT	TYPE 6 COLUMNAR
MIN. DIA. ROOTBALL	MIN. DIA. ROOTBALL	MIN. DIA. ROOTBALL
1 1/2 IN	12 IN	12 IN
2 IN	14 IN	14 IN
2 1/2 IN	16 IN	16 IN
3 IN	18 IN	18 IN
3 1/2 IN	20 IN	20 IN
4 IN	22 IN	22 IN
4 1/2 IN	24 IN	24 IN
5 IN	26 IN	26 IN
5 1/2 IN	28 IN	28 IN
6 IN	30 IN	30 IN
6 1/2 IN	32 IN	32 IN
7 IN	34 IN	34 IN
7 1/2 IN	36 IN	36 IN
8 IN	38 IN	38 IN

CONIFER PLANTING AND STAKING NOT TO SCALE

- LANDSCAPE NOTES:**
- INDIVIDUAL LOT LANDSCAPING SHALL BE PLANTED PRIOR TO THE ISSUANCE OF A USE AND OCCUPANCY PERMIT UNLESS WEATHER/TIME OF YEAR PROHIBITS.
 - GUARANTEE: ALL PLANT MATERIAL SHALL BE GUARANTEED FOR TWELVE (12) MONTHS FROM THE DAY OF FINAL APPROVAL BY THE TOWN ARBORIST OR TOWN ENGINEER. ANY PLANT MATERIAL TWENTY-FIVE PERCENT (25%) OR MORE OF WHICH IS DEAD SHALL BE CONSIDERED DEAD. A TREE SHALL BE CONSIDERED DEAD WHEN THE MAIN LEADER HAS DIED OR TWENTY-FIVE PERCENT (25%) OF THE CROWN IS DEAD. IF THE PLANT FAILS TO SURVIVE DURING THIS PERIOD, REPLACEMENT SHALL BE MADE AT THE BEGINNING OF THE FIRST SUCCESSIVE PLANTING SEASON. ALL REPLACEMENTS SHALL HAVE A GUARANTEE EQUAL TO THAT STATED ABOVE. ANY DEAD PLANT MATERIAL SHALL BE REPLACED AND INSTALLED ACCORDING TO THE APPROVED PLANTING PRACTICES.
 - ALL PLANT MATERIAL SHALL BE STAKED IN THE FIELD AND LOCATIONS APPROVED BY THE LANDSCAPE ARCHITECT PRIOR TO PLANTING.
 - PROPOSED PLANT MATERIAL MAY BE SUBSTITUTED WITH A SIMILAR PLANT PRIOR TO INSTALLATION BASED ON AVAILABILITY, SUBJECT TO APPROVAL BY ESE LANDSCAPE ARCH/TOLL BROS. INC. AND THE TOWN'S AGENT
 - IN THE EVENT THAT ANY DISCREPANCIES BETWEEN THE QUANTITIES OF PLANTS INDICATED ON THE PLAN SCHEDULE AND THOSE INDICATED ON THE PLAN, THE QUANTITIES INDICATED ON THE PLAN SHALL GOVERN.
 - NOTIFY ALL UTILITY COMPANIES PRIOR TO EXCAVATING PLANT PITS. PLANT LOCATIONS MAY BE ADJUSTED IN FIELD TO AVOID INTERFERENCE WITH UTILITIES.
 - THE CONTRACTOR SHALL BE RESPONSIBLE FOR PLANTING AT CORRECT GRADES AND ALIGNMENT.
 - PLANTS SHALL BE TYPICAL OF THEIR SPECIES AND VARIETY HAVE NORMAL GROWTH HABITS, WELL DEVELOPED BRANCHES, DENSELY FOLIATED, VIGOROUS ROOT SYSTEMS AND BE FREE FROM DEFECTS AND INJURIES.
 - THE CONTRACTOR SHALL REPORT ANY SOIL OR DRAINAGE CONDITION CONSIDERED DETRIMENTAL TO THE GROWTH OF PLANT MATERIAL.
 - QUALITY AND SIZE OF PLANTS, SPREAD OF ROOTS AND SIZE OF BALLS SHALL BE IN ACCORDANCE WITH "AMERICAN STANDARDS FOR NURSERY STOCK" ANSI 260 (MOST RECENT EDITION) AS PUBLISHED BY THE AMERICAN ASSOCIATION OF NURSERYMEN, INC.
 - B & B PLANTS SHALL BE HANDLED FROM THE BOTTOM OF THE ROOT BALL ONLY. PLANTS WITH BROKEN, SPLIT OR DAMAGED ROOT BALLS SHALL BE REJECTED.
 - TREES SHALL BE LOCATED IN A MANNER WHICH WILL NOT OBSTRUCT ACCESS TO FIRE HYDRANT OR VISIBILITY OF STREET OR TRAFFIC SIGNS. NO TREES OR SHRUBS SHALL BE PLANTED IN A SIGHT TRIANGLE. NO TREES SHALL BE PLANTED IN ANY UTILITY OR MUNICIPAL EASEMENTS.
 - PLANTING OPERATIONS SHALL BE PERFORMED DURING PERIODS WITHIN THE PLANTING SEASON WHEN WEATHER AND SOIL CONDITION ARE SUITABLE. SPRING PLANTING SEASON SHALL BE MARCH 21 TO MAY 30 FOR DECIDUOUS / APRIL 1 TO JUNE 15 FOR EVERGREEN. FALL PLANTING SEASON SHALL BE: OCTOBER 1 TO DECEMBER 1 FOR DECIDUOUS / AUGUST 15 TO OCTOBER 15 FOR EVERGREEN.
 - SET ALL PLANTS PLUMB AND STRAIGHT. SET AT SUCH LEVEL THAT, AFTER SETTLEMENT, A NORMAL OR NATURAL RELATIONSHIP TO THE GROUND OF THE PLANT WITH THE GROUND SURFACE WILL BE ESTABLISHED. LOCATE PLANTS IN THE CENTER OF THE PLANTING PIT.
 - TREES SHALL BE SUPPORTED IMMEDIATELY AFTER PLANTING IN ACCORDANCE WITH THE PLANTING DETAILS.
 - THE CONTRACTOR SHALL GIVE ALL NOTICES AND COMPLY WITH ALL LAWS, ORDINANCES, RULES, REGULATIONS AND LAWFUL ORDERS OF ANY PUBLIC AUTHORITY BEARING UPON THE PERFORMANCE OF THE WORK.
 - TREE PROTECTION DURING CONSTRUCTION: TREE PROTECTION AREAS SHALL BE DELINEATED TO IMPLEMENT THE STANDARDS CONTAINED IN THE TOWNSHIP ZONING ORDINANCE AND THIS ORDINANCE REGARDING PRESERVATION OF TREES, WOODLANDS, AND FORESTS DURING THE DEVELOPMENT AND CONSTRUCTION PROCESS.
 - TREE PROTECTION AREA: AN AREA THAT IS RADIAL TO THE TRUNK OF A TREE. THE TREE PROTECTION AREA SHALL BE 15 FEET FROM THE TRUNK OF THE TREE TO BE RETAINED, OR THE DISTANCE FROM THE TRUNK TO THE DRIP LINE (THE LINE MARKING THE OUTER EDGE OF THE BRANCHES OF THE TREE) WHICHEVER IS GREATER, WHERE THERE IS A GROUP OF TREES OR WOODLANDS, THE TREE PROTECTION AREA SHALL BE THE AGGREGATE OF THE PROTECTION AREAS FOR THE INDIVIDUAL TREES.
 - FERTILIZER USE AND APPLICATION MUST COMPLY WITH 330 CMR FOR LAND NOT USED FOR AGRICULTURAL PURPOSES. SOILS TESTING REQUIRED PRIOR TO APPLYING ANY PHOSPHOROUS CONTAINING FERTILIZER.

- LIGHTING NOTES:**
- SEE SHEET LS-4 FOR LIGHT FIXTURE SPECIFICATIONS.

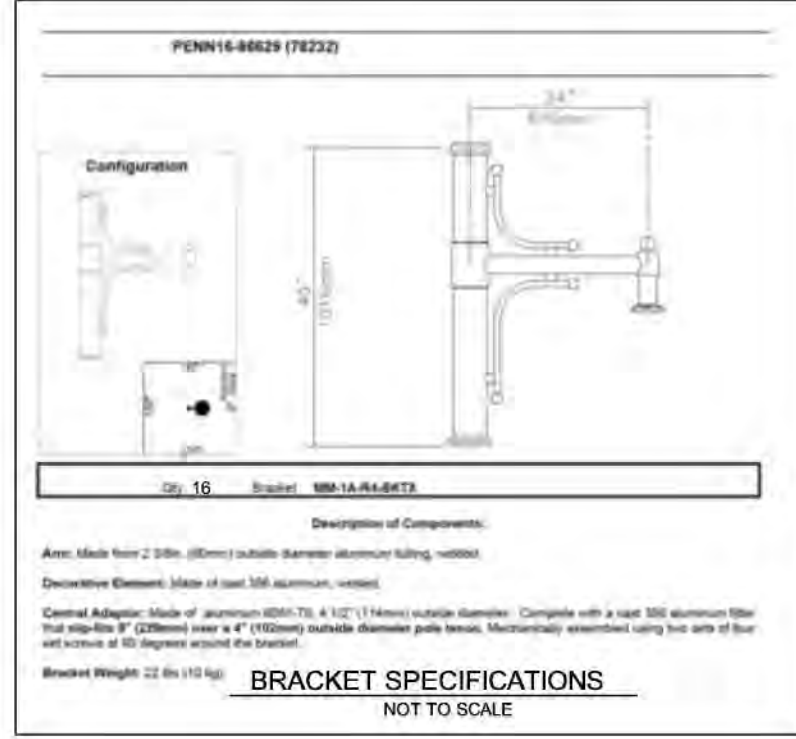

PLANT SCHEDULE

TREES	BOTANICAL NAME	COMMON NAME	CONT	SIZE	QTY
AR	ACER RUBRUM	RED MAPLE	B & B	2" CAL.	45
AM	AMELANCHIER CANADENSIS	SHADBLow SERVICEBERRY MULTITRUNK	B & B	8' MIN. HT.	88
BC	BETULA NIGRA 'CULLY' TM	HERITAGE BIRCH	B & B	8' MIN. HT.	47
CK	CORNUS KOUSA	KOUSA DOGWOOD	B & B	8' MIN. HT.	29
JE	JUNIPERUS VIRGINIANA	EASTERN RED CEDAR	B & B	5'-6" HT.	108
MM	MAGNOLIA STELLATA	STAR MAGNOLIA MULTI-TRUNK	B & B	8' MIN. HT.	16
NS	NYSSA SYLVATICA	SOUR GUM	B & B	2" CAL.	12
OA	OXYDENDRUM ARBOREUM	SOURWOOD TREE	B & B	2" CAL.	18
PG	PICEA GLAUCA	WHITE SPRUCE	B & B	8' MIN. HT.	57
PP	PICEA PUNGENS	COLORADO SPRUCE	B & B	8' MIN. HT.	49
PS	PINUS STROBUS	WHITE PINE	B & B	8' MIN. HT.	80
QP	QUERCUS PALUSTRIS	PIN OAK	B & B	2 1/2" CAL.	19
STREET TREES	BOTANICAL NAME	COMMON NAME	CONT	SIZE	QTY
AG	ACER RUBRUM 'OCTOBER GLORY' TM	OCTOBER GLORY MAPLE	B & B	2 - 2 1/2" CAL.	24
AS	ACER SACCHARUM	SUGAR MAPLE	B & B	2 1/2" CAL.	27
AF	AESCULUS X CARNEA 'FORT MCNAIR'	RED HORSECHESTNUT	B & B	2 - 2 1/2" CAL.	15
AA	AMELANCHIER ARBOREA 'ROBIN HILL' SINGLE STEM	ROBIN HILL SERVICEBERRY	B & B	1 1/2" MIN. CAL.	21
CV	CHIONANTHUS VIRGINICUS	WHITE FRINGETREE	B & B	1 1/2" MIN. CAL.	11
GI	GLEDITSIA TRIACANTHOS INERMIS	THORNLESS COMMON HONEYLOCUST	B & B	2 - 2 1/2" CAL.	21
MS	MALUS X 'SUGAR TYME' TM	SUGAR TYME CRAB APPLE	B & B	2 1/2" CAL.	5
TG	TILIA CORDATA 'GREENSPIRE'	GREENSPIRE LITTLELEAF LINDEN	B & B	2 - 2 1/2" CAL.	26
SHRUBS	BOTANICAL NAME	COMMON NAME	CONT.	SIZE	QTY
CA	CLETHRA ALNIFOLIA	SUMMERSWEET CLETHRA	24"-36" HT.		55
IV	ILEX VERTICILLATA 'WINTER RED'	WINTER RED HOLLY	24"-36" HT.		17
MP	MYRICA PENNSYLVANICA	NORTHERN BAYBERRY	24"-36" HT.		23
PC	PHYSCARPUS OPULIFOLIUS 'COPPERTINA'	COPPERTINA NINEBARK	24"-36" HT.		18
PL	PRUNUS LAUROCERASUS 'SCHIPKAENSIS'	SCHIPKA LAUREL	36" HT. MIN.		61
VL	VIBURNUM LENTAGO	NANNYBERRY	24"-36" HT.		70

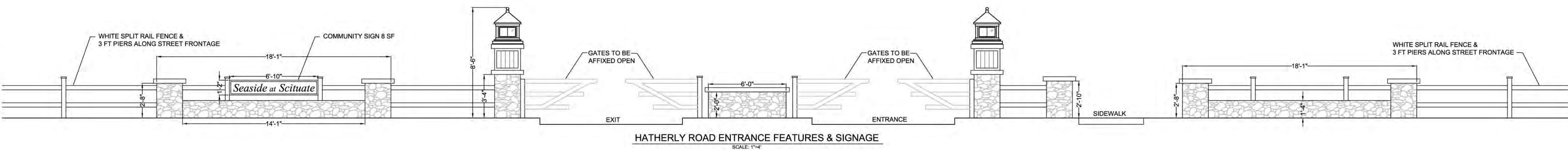
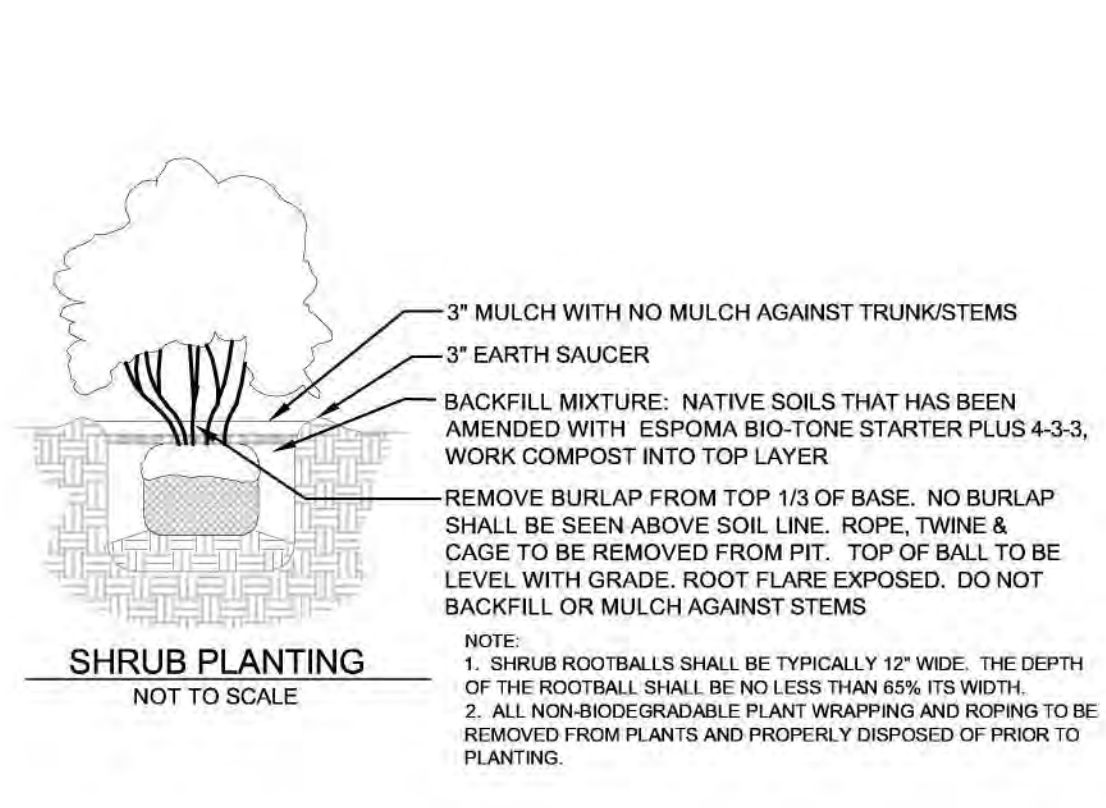
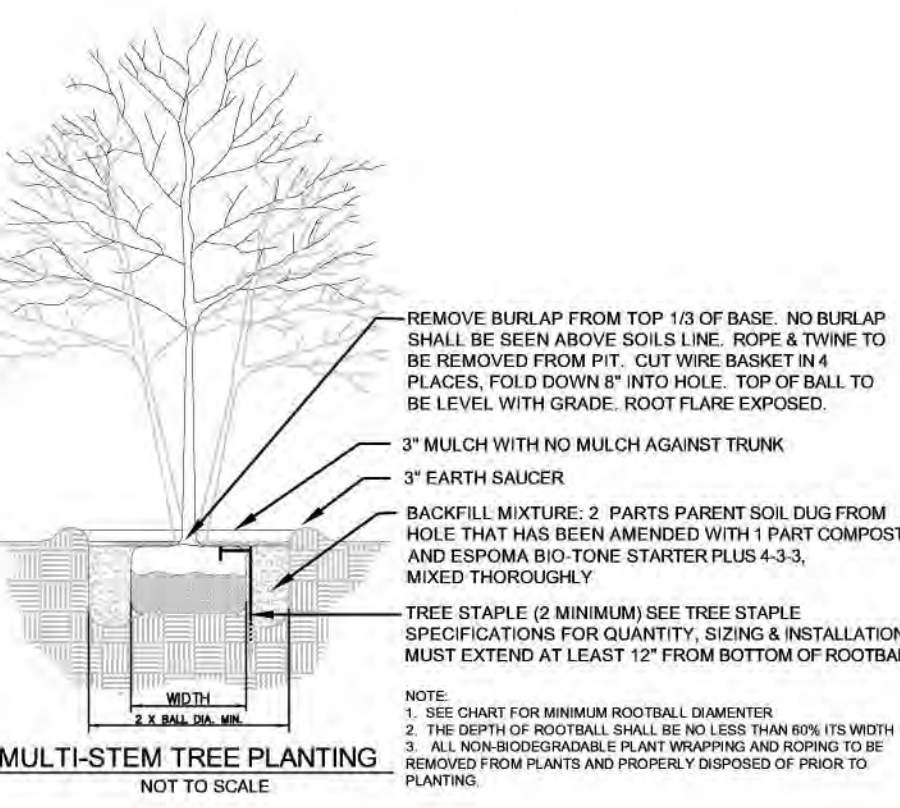

HATHERLY ROAD ENTRANCE FEATURES & SIGNAGE SCALE: 1"=4'



TILDEN ROAD ENTRANCE FEATURES SCALE: 1"=4'



ESE CONSULTANTS
 ENGINEERING • PLANNING • SURVEYING • ENVIRONMENTAL
 ESE Consultants, Inc.
 250 Gibraltar Road • Suite 2E • Horsham, PA 19044
 T: 215-914-2050

PLAN REVISIONS

REV.	DATE	DESCRIPTION

PROJECT NAME:
SEASIDE AT SCITUATE

PROJECT LOCATION:
 TOWN OF SCITUATE
 PLYMOUTH COUNTY
 MASSACHUSETTS

SHEET TITLE:
LANDSCAPE DETAILS

DATE: 2017.04.20	SCALE: AS NOTED
DESIGN: EES	DRAWN: EES
JOB NO.: 3599	FILE NAME: S-DET-LAND
REF: SD09.06	
SHEET NO.: 6 OF 10	

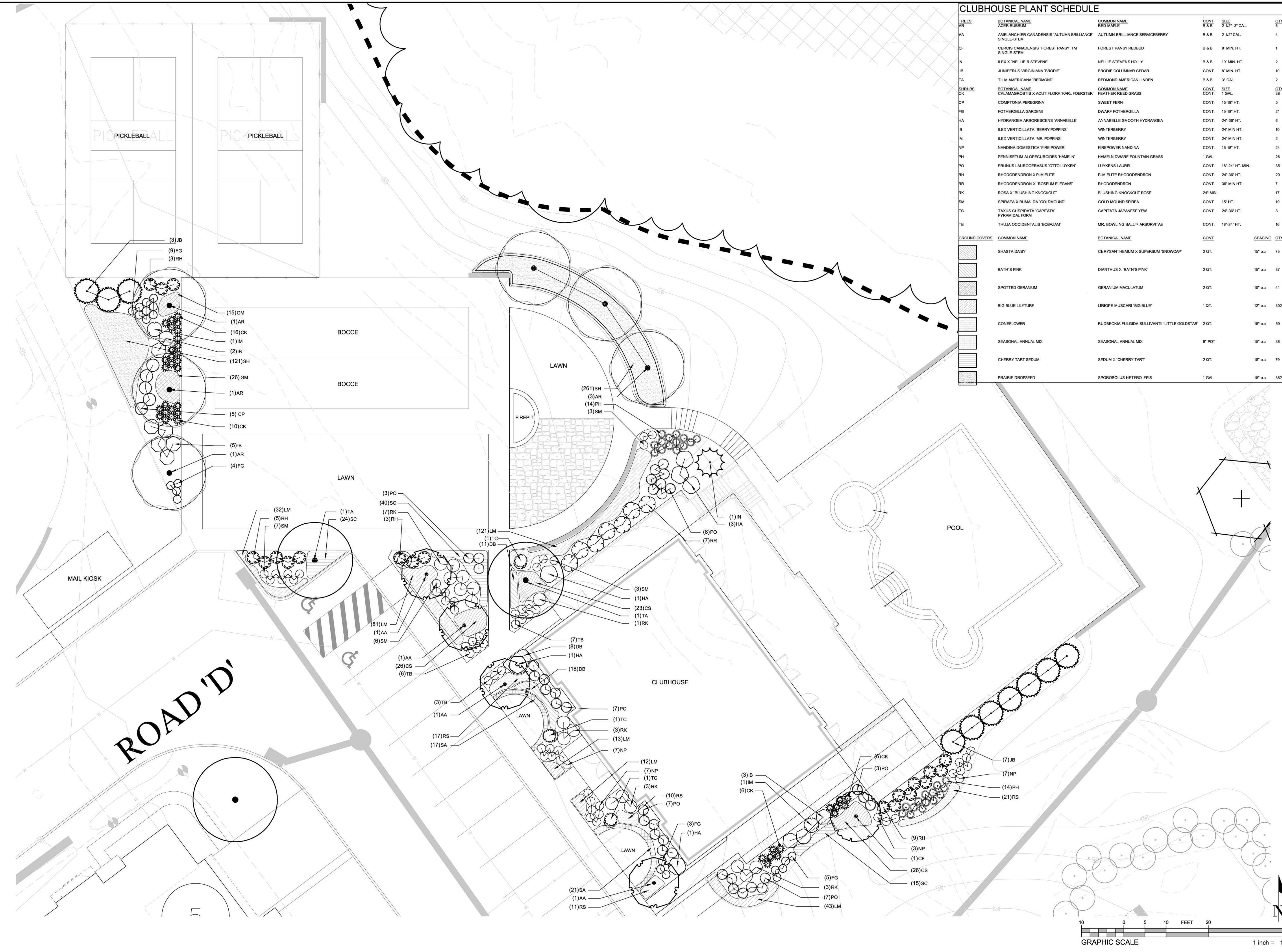

CLUBHOUSE PLANT SCHEDULE

TREES	BOTANICAL NAME	COMMON NAME	CONT.	SIZE	QTY
AR	ACER RUBRUM	RED MAPLE	B & B	2 1/2' - 3' CAL.	6
AA	AMELANCHIER CANADENSIS 'AUTUMN BRILLIANCE'	AUTUMN BRILLIANCE SERVICEBERRY	B & B	2 1/2' CAL.	4
CF	CERCIS CANADENSIS 'FOREST PANSY' TM	FOREST PANSY REDBUD	B & B	8' MIN. HT.	1
IN	ILEX X 'NELLIE R STEVENS'	NELLIE STEVENS HOLLY	B & B	10' MIN. HT.	2
JB	JUNIPERUS VIRGINIANA 'BRODIE'	BRODIE COLUMNAR CEDAR	CONT.	8' MIN. HT.	10
TA	TILIA AMERICANA 'REDMOND'	REDMOND AMERICAN LINDEN	B & B	3' CAL.	2
SHRUBS	BOTANICAL NAME	COMMON NAME	CONT.	SIZE	QTY
CK	CALAMAGOSTIS X ACUTIFLORA 'KARL FOERSTER'	FEATHER REED GRASS	1 GAL.	1 GAL.	38
CP	COMPSONIA PEREGRINA	SWEET FERN	CONT.	15-18" HT.	5
FG	FOTHERGILLA GARDENII	DWARF FOTHERGILLA	CONT.	15-18" HT.	21
HA	HYDRANGEA ARBORESCENS 'ANNABELLE'	ANNABELLE SMOOTH HYDRANGEA	CONT.	24'-30" HT.	6
IB	ILEX VERTICILLATA 'BERRY POPPINS'	WINTERBERRY	CONT.	24" MIN HT.	10
IM	ILEX VERTICILLATA 'MR. POPPINS'	WINTERBERRY	CONT.	24" MIN HT.	2
NP	NANDINA DOMESTICA 'FIRE POWER'	FIREPOWER NANDINA	CONT.	15-18" HT.	24
PH	PENNSETUM ALOPECUROIDES 'HAMELN'	HAMELN DWARF FOUNTAIN GRASS	1 GAL.	1 GAL.	28
PO	PRUNUS LAUROCEARASUS 'OTTO LUYKEN'	LUYKEN'S LAUREL	CONT.	18"-24" HT. MIN.	35
RH	RHOODOENDRON X PAM ELITE	PAM ELITE RHOODOENDRON	CONT.	24'-30" HT.	20
RR	RHOODOENDRON X 'ROSEUM ELEGANS'	RHOODOENDRON	CONT.	30' MIN HT.	7
RK	ROSA X 'BLUSHING KNOCKOUT'	BLUSHING KNOCKOUT ROSE	24" MIN.		17
SM	SPIRAEA X BUMALDA 'GOLDMOUND'	GOLD MOUND SPIREA	CONT.	19" HT.	19
TC	TAXUS CUSSPIDATA 'CAPITATA' PYRAMIDAL FORM	CAPITATA JAPANESE YEW	CONT.	24'-30" HT.	3
TB	THUJA OCCIDENTALIS 'BOBZAM'	MR. BOWLING BALL™ ARBORVITAE	CONT.	18"-24" HT.	16
GROUND COVERS					
	BOTANICAL NAME	COMMON NAME	CONT.	SPACING	QTY
	SHASTA DAWY	SHASTA DAWY	2 QT.	15" o.c.	75
	BATH'S PINK	DIANTHUS X 'BATH'S PINK'	2 QT.	15" o.c.	37
	SPOTTED GERANIUM	GERANIUM MACULATUM	2 QT.	15" o.c.	41
	BIG BLUE LILYTURF	LIRIOPE MUSCARI 'BIG BLUE'	1 QT.	12" o.c.	302
	CONEFLOWER	RUDIBECKIA FULGIDA SULLIVANTI 'LITTLE GOLDSTAR'	2 QT.	15" o.c.	59
	SEASONAL ANNUAL MIX	SEASONAL ANNUAL MIX	8" POT	15" o.c.	38
	CHERRY TART SEDUM	SEDUM X 'CHERRY TART'	2 QT.	15" o.c.	79
	PRAIRIE DROPS EED	SPOROBOLUS HETEROLEPIS	1 GAL.	15" o.c.	382

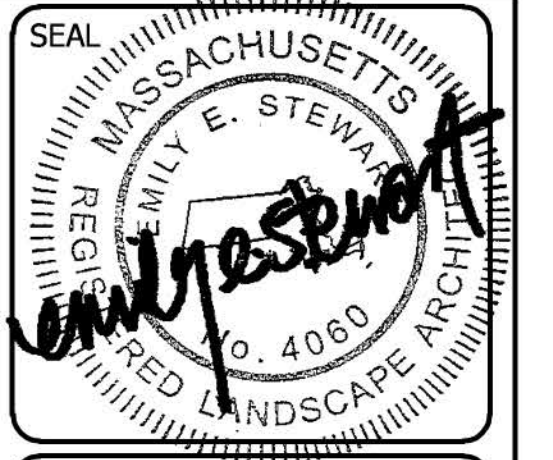

ESE CONSULTANTS
 ENGINEERING • PLANNING • SURVEYING • ENVIRONMENTAL
 ESE Consultants, Inc.
 250 Gibraltar Road • Suite 2E • Horsham, PA 19044
 T: 215-914-2050

PLAN REVISIONS

REV.	DATE	DESCRIPTION

PROJECT NAME:
SEASIDE AT SCITUATE

PROJECT LOCATION:
 TOWN OF SCITUATE
 PLYMOUTH COUNTY
 MASSACHUSETTS

SHEET TITLE:
CLUBHOUSE LANDSCAPE PLAN

DATE: 2017.04.20
 SCALE: 1"=10'
 DESIGN: EES
 DRAWN: EES
 JOB NO.: 3599
 FILE NAME: S-DET-LAND
 REF.: SD09.07
 SHEET NO.: 7 OF 10

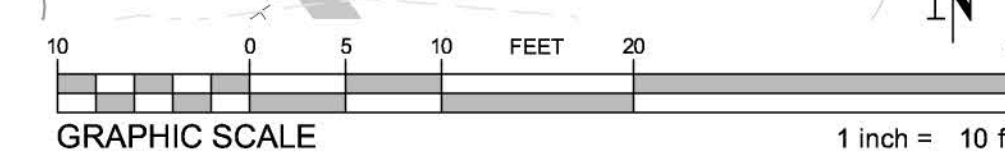

Apr 20, 2017 - 5:11 pm N:\Projects\Massachusetts\2017 Seaside at Scituate (04)\Landscape\Drawings\2017 S-DET-LAND.dwg

SMALL TREES				
SYMBOL	QUANTITY	SPECIES/COMMON NAME	SIZE	NOTES
		Cornus mas / Cornelian Cherry Dogwood	5'-6" HT	Full Sun/Part Shade
		Hibiscus syriacus / Rose of Sharon	5'-6" HT	Full Sun/Part Shade
		Ilex x aquipernyi 'Meschick' / Dragon Lady Holly	5'-6" HT	Full Sun/Part Shade
		Juniperus chinensis 'Blue Point' or 'Spartan' / Juniper	5'-6" HT	Full Sun
		Magnolia stellata / 'Royal Star' Magnolia	5'-6" HT	Full Sun
		Picea glauca 'Conica' or 'Fat Albert' / Dwarf Alberta Spruce	5'-6" HT	Full Sun/Part Shade
		Thuja occidentalis 'Nigra' / Arborvitae	5'-6" HT	Full Sun/Part Shade

LARGE-MEDIUM SHRUB A (DECIDUOUS) SELECT ONE SPECIES ONLY PER PLANT GROUPING				
SYMBOL	QUANTITY	SPECIES/COMMON NAME	SIZE	NOTES
		Azalea varieties / Deciduous Azalea	36" MIN. HT	Full Sun/Part Shade
		Clethra alnifolia 'Ruby Spice' / Summersweet Clethra	36" MIN. HT	Full Sun/Part Shade
		Hydrangea macrophylla 'Endless Summer' TM / Hydrangea	36" MIN. HT.	Full Sun/Part Shade
		Hydrangea quercifolia / Oakleaf Hydrangea	36" MIN. HT.	Full Sun/Part Shade
		Physocarpus opulifolius 'Summer Wine' or 'Coppertina' / Ninebark	36" MIN. HT.	Full Sun/Part Shade
		Rosa rugosa 'Radtko' / Double Knock Out Rose	36" MIN. HT.	Full Sun
		Weigela florida / Compact Variety	36" MIN. HT.	Full Sun/Part Shade

LARGE-MEDIUM SHRUB B (EVERGREEN) SELECT ONE SPECIES ONLY PER PLANT GROUPING				
SYMBOL	QUANTITY	SPECIES/COMMON NAME	SIZE	NOTES
		Azalea varieties / Evergreen Azalea		Full Sun/Part Shade
		Ilex crenata 'Compacta' / Japanese Holly	24" MIN. HT	Full Sun/Part Shade
		Daphne x burkwoodii 'Carol Mackie' / Daphne	24" MIN. HT.	Full Sun/Part Shade
		Ilex glabra 'Densa' or 'Shamrock' / Inkberry	24" MIN. HT.	Full Sun/Full Shade
		Ilex x 'Mesog' / China Boy & China Girl Holly	24" MIN. HT.	Full Sun/Full Shade
		Leucothoe axillaris / Coastal Leucothoe	24" MIN. HT.	Part Shade/Full Shade
		Pieris japonica 'Compacta' / Japanese Andromeda	24" MIN. HT.	Full Sun/Full Shade
		Prunus laurocerasus 'Otto Luyken' / Cherry Laurel	24" MIN. HT.	Full Sun/Part Shade

SMALL SHRUB C (DECIDUOUS) SELECT ONE SPECIES ONLY PER PLANT GROUPING				
SYMBOL	QUANTITY	SPECIES/COMMON NAME	SIZE	NOTES
		Caryopteris 'Blue Mist' or 'Dark Knight' / Dwarf Bluebeard	18" MIN. HT	Full Sun
		Itea virginica 'Little Henry' / Dwarf Virginia Sweetpire	18" MIN. HT.	Full Sun/Full Shade
		Hypericum x 'Hydcote' / St. John's Wort	18" MIN. HT.	Full Sun/Part Shade
		Nandina domestica 'Firepower' / Nandina	18" MIN. HT.	Full Sun/Full Shade

SMALL SHRUB D (EVERGREEN) SELECT ONE SPECIES ONLY PER PLANT GROUPING				
SYMBOL	QUANTITY	SPECIES/COMMON NAME	SIZE	NOTES
		Ilex glabra 'Compacta' / Compact Inkberry	18" MIN. HT.	Full Sun/Full Shade
		Thuja occidentalis 'Hetz Midget' / Arborvitae	18" MIN. HT.	Full Sun/Part Shade
		Thuja occidentalis 'Bobozam' / Arborvitae	18" MIN. HT.	Full Sun/Part Shade

PERENNIAL MIX A: FULL SUN SELECT 2-4 SPECIES				
SYMBOL	QUANTITY	SPECIES/COMMON NAME	SIZE	NOTES
		Coreopsis / Tickseed	1 GAL.	Full Sun
		Chrysanthemum nipponicum / Montauk Daisy	1 GAL.	Full Sun
		Hemerocallis / Daylily	1 GAL.	Full Sun
		Phlox paniculata / Garden Phlox	1 GAL.	Full Sun
		Rudbeckia fulgida var. fulgida / Black Eyed Susan	1 GAL.	Full Sun
		Sedum 'Autumn Joy' / Stonecrop	1 GAL.	Full Sun

PERENNIAL MIX B: SHADE SELECT 2-4 SPECIES				
SYMBOL	QUANTITY	SPECIES/COMMON NAME	SIZE	NOTES
		Astible / Falsespirea	1 GAL.	Part Shade/Full Shade
		Fern	1 GAL.	Part Shade/Full Shade
		Hosta	1 GAL.	Part Shade/Full Shade
		Tiarella cordifolia / Foamflower	1 GAL.	Part Shade/Full Shade

GROUNDCOVER SELECT ONE SPECIES ONLY				
SYMBOL	QUANTITY	SPECIES/COMMON NAME	SIZE	NOTES
		Arctostaphylos uva-ursi / Common Bearberry	1 QT.	Full Sun
		Iberis sempervirens / Candytuft	1 QT.	Full Sun
		Liriope muscari 'Big Blue' / Liriope	1 QT.	Part Shade/Full Shade
		Mahonia aquifolium 'Compacta' / Compact Oregon Grape Holly	1 QT.	Full Sun/Part Shade
		Pachysandra terminalis / Japanese Spurge	1 QT.	Part Shade/Full Shade
		Phlox subulata / Creeping Phlox	1 QT.	Full Sun
		Vinca minor / Periwinkle	1 QT.	Full Sun/Full Shade

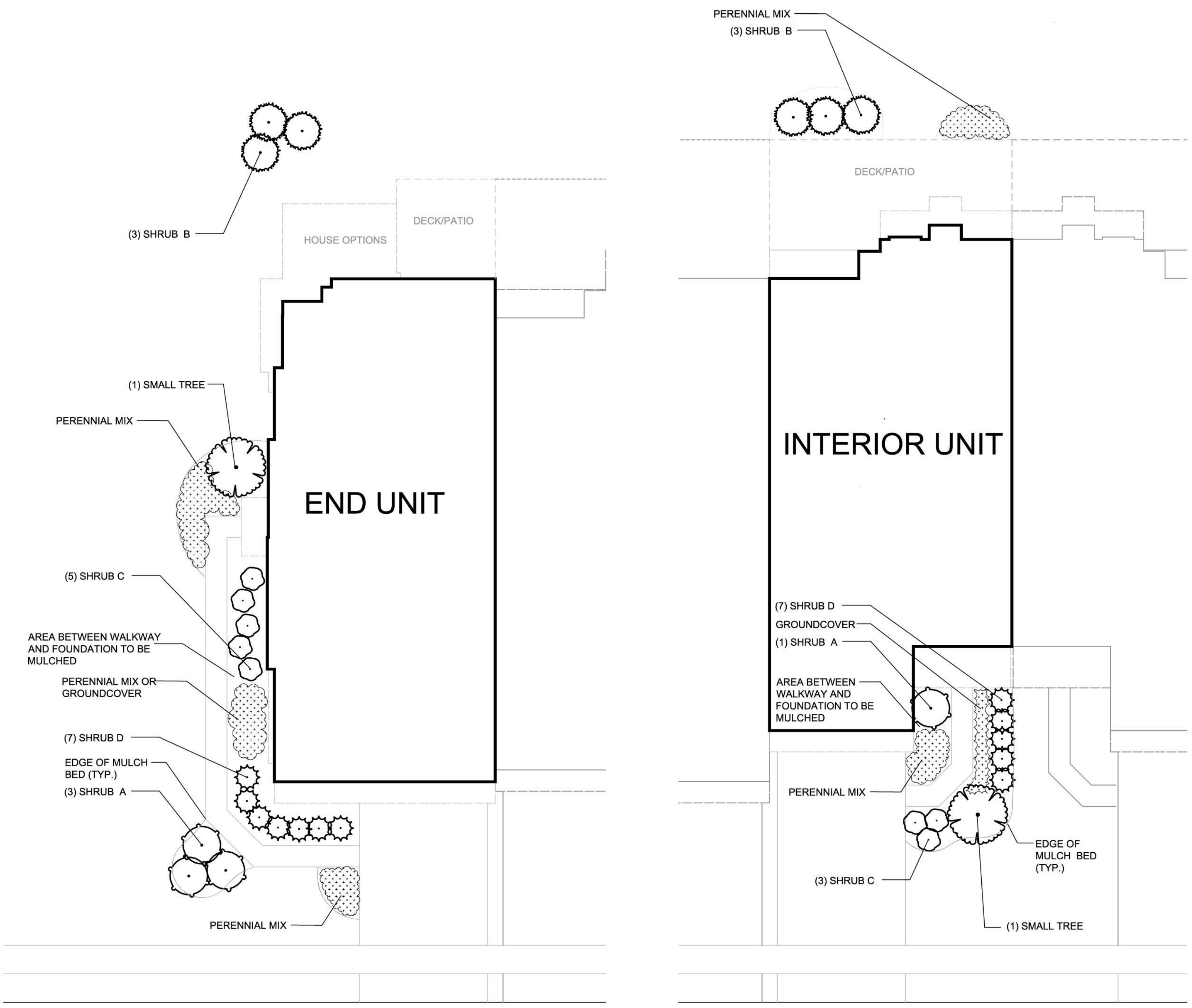

TYPICAL END UNIT PLANTINGS

SCALE: 1"=10'

- (1) SMALL TREE
- (3) LARGE/MEDIUM SHRUB A
- (3) LARGE/MEDIUM SHRUB B
- (5) SMALL SHRUB C
- (7) SMALL SHRUB D
- PERENNIAL MIX/GROUNDCOVER

TYPICAL INTERIOR UNIT PLANTINGS

SCALE: 1"=10'

- (1) SMALL TREE
- (1) LARGE/MEDIUM SHRUB A
- (3) LARGE/MEDIUM SHRUB B
- (3) SMALL SHRUB C
- (5) SMALL SHRUB D
- PERENNIAL MIX/GROUNDCOVER

NOTES:
 1. ABOVE DIAGRAMS ARE CONCEPTUAL. ALL PLANT LOCATIONS & QUANTITIES WILL VARY BASED ON HOUSE MODEL/OPTIONS, PROPOSED DECK/PATIO LOCATIONS AND GENERAL SITE CONDITIONS.
 2. FOUNDATION PLANTS ARE IN ADDITION TO AND ARE TO BE COORDINATED WITH PROPOSED STREET TREES, OPEN SPACE PLANTINGS AND EXISTING VEGETATION TO REMAIN.
 3. REFER TO SHEET SD09.07 FOR LANDSCAPE NOTES AND PLANTING DETAILS.

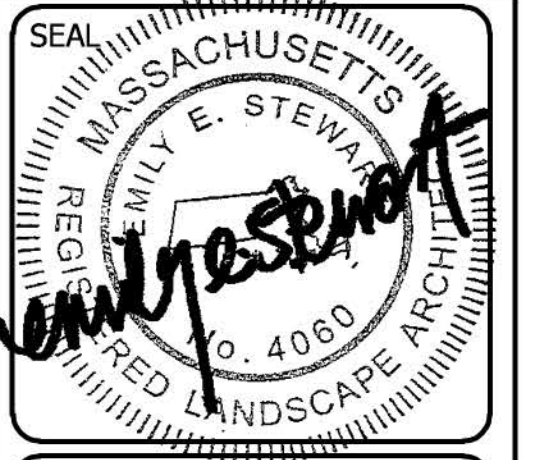
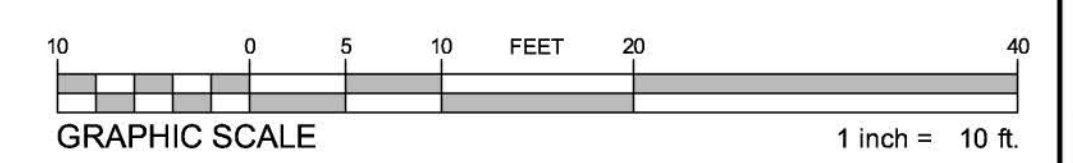

ESE CONSULTANTS
 ENGINEERING • PLANNING • SURVEYING • ENVIRONMENTAL
 ESE Consultants, Inc.
 250 Gibraltar Road • Suite 2E • Horsham, PA 19044
 T: 215-914-2050

PLAN REVISIONS		
REV.	DATE	DESCRIPTION

PROJECT NAME:
SEASIDE AT SCITUATE

PROJECT LOCATION:
 TOWN OF SCITUATE
 PLYMOUTH COUNTY
 MASSACHUSETTS

SHEET TITLE:
TYPICAL LOT LANDSCAPE PLAN

DATE: 2017.04.20	SCALE: 1"=10'
DESIGN: EES	DRAWN: EES
JOB NO.: 3599	FILE NAME: S-DET-LAND
REF: SD09.08	
SHEET NO.:	8 OF 10

