

The Cottages at Old Oaken Bucket
Old Oaken Bucket Road
Scituate, MA

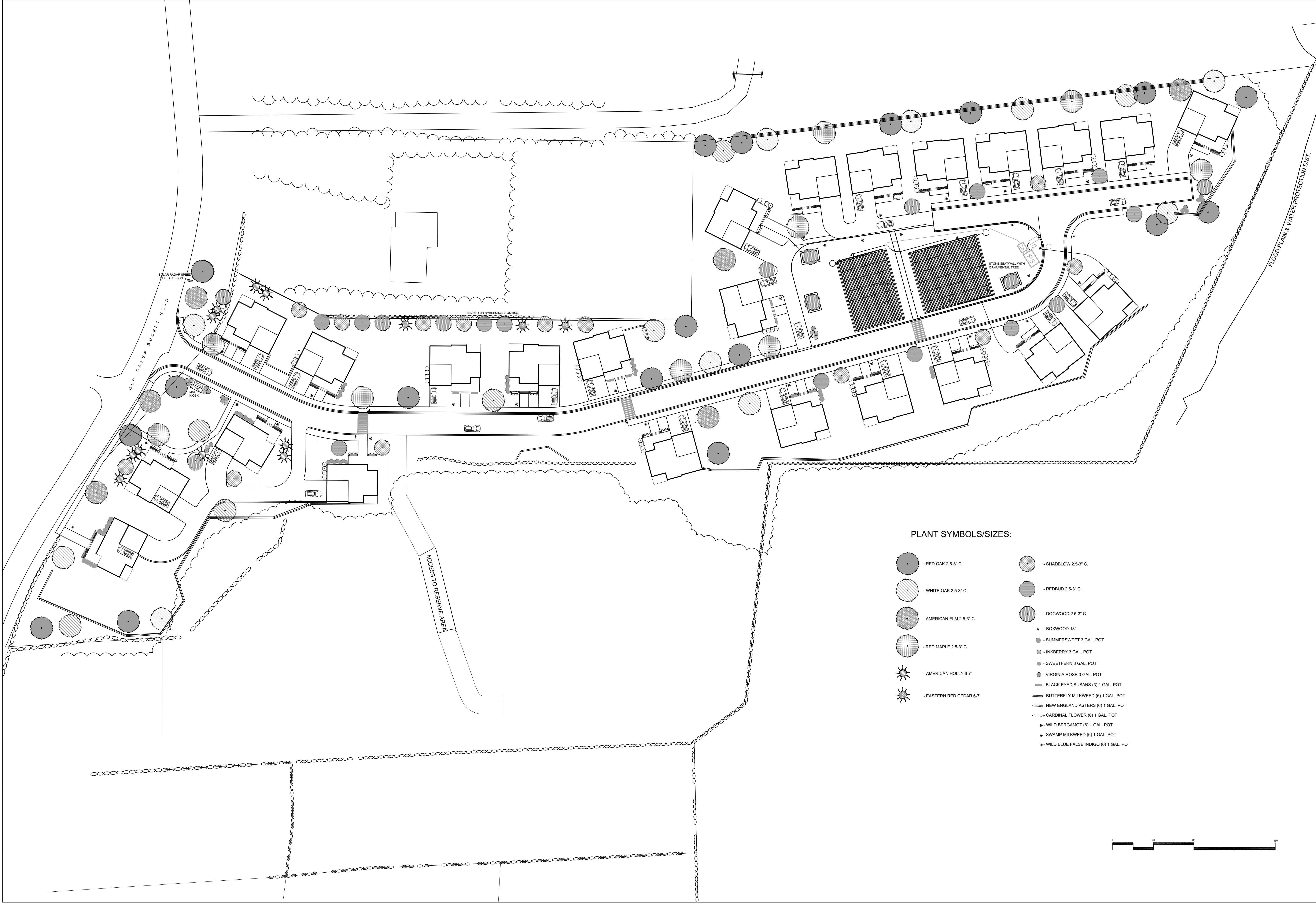

PLANT SYMBOLS/SIZES:

- RED OAK 2.5-3' C.
- WHITE OAK 2.5-3' C.
- AMERICAN ELM 2.5-3' C.
- RED MAPLE 2.5-3' C.
- AMERICAN HOLLY 6-7'
- EASTERN RED CEDAR 6-7'
- SHADBLOW 2.5-3' C.
- REDBUD 2.5-3' C.
- DOGWOOD 2.5-3' C.
- BOXWOOD 18"
- SUMMERSWEET 3 GAL. POT
- INKBERRY 3 GAL. POT
- SWEETFERN 3 GAL. POT
- VIRGINIA ROSE 3 GAL. POT
- BLACK EYED SUSANS (3) 1 GAL. POT
- BUTTERFLY MILKWEED (6) 1 GAL. POT
- NEW ENGLAND ASTERS (6) 1 GAL. POT
- CARDINAL FLOWER (6) 1 GAL. POT
- WILD BERGAMOT (6) 1 GAL. POT
- SWAMP MILKWEED (6) 1 GAL. POT
- WILD BLUE FALSE INDIGO (6) 1 GAL. POT

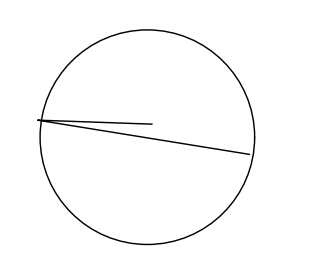

February 7, 2023

LANDSCAPE PLAN

L-1

