

Scituate Community Preservation Committee Funding Request Form

DATE and YEAR of Application: December 5, 2018

APPLICANT INFORMATION

Project Sponsor or Organization: Town of Scituate

Contact Name & Address: Lorraine Devin, 600 Chief Justice Cushing Hwy, Scituate, MA 02066

Telephone Number: 781-545-8740

Email: ldevin@scituatema.gov

PROJECT INFORMATION

CPA CATEGORY (check all that apply):

OPEN SPACE

RECREATION

HISTORIC PRESERVATION

COMMUNITY HOUSING

NAME OF PROJECT: Cole Parkway Harborwalk Morrill Bandstand/Gazebo, Benches & Trash Receptacles

BRIEF DESCRIPTION OF PROJECT: Remove broken and rusty benches, purchase and install 11 new benches

& 6 trash receptacles along the Cole Parkway Harborwalk area from Harbormasters office up to Front Street.

Rehabilitation of the gazebo; needs new decking, railings, structural columns, selective skirting, trim replacement, upgrade electrical, painting and install new roof.

Attach additional pages including summary, budget, estimated timeline and justification of need.

Project Location or Address: Cole Parkway, Harborwalk, 0 Cole Parkway, Scituate, MA

Include map, photo and other imagery for ALL category projects.

If Open Space or Community Housing:

Assessor's Map Page, Block & Lot Number: 50-7-28-0

Number of acres in parcel: 5.25 acres

Current Zoning Classification: Business Zone-Village Business Districe AE15 Zone

Assessed Value: \$1,392,100

Title in name of: Town of Scituate

Title Abstract Date: _____

Number of housing units proposed: N/A

Summarize how this request benefits the Town of Scituate and meets the goals of the Community Preservation Act.

Thousands of residents, visitors and boaters enjoy the Cole Parkway Harborwalk area. It is rundown and broken and in need of attention. Rehabilitation of existing, outdoor recreational facilities to include the replacement of park benches, trash receptacles and the gazebo to make them more functional for their intended recreational use. This location is part of our Scituate Harbor Cultural District and Harborwalk area.

PERMITS AND APPROVALS

What permits and approvals are required? Have they been obtained or have you filed for them?

Name of Permit	Filed? (Y/N)	Filed (Date)	Obtained (Date)
Minor activities permit	No	2 weeks before start	TBD

Have you met with any other Town Boards or committees? If so, what were the outcomes of those meetings? *(Letters of support from other Boards and committees should be included in the application or supplied at a later date.)*

Discussed with Recreation Director who has put on the Recreation Commission agenda for support. Met with harbormaster, DPW Director and Facilities Manager who support the project and will be involved.

Notes: _____

What non-financial support and services are necessary, and how will these be provided?

DPW support will be required to manage preparation and installation of benches and trash receptacles. Met with Kevin Cafferty, DPW Superintendent and he has agreed to provide support and services as DPW has in the past.

FUNDING

Describe the proposed funding for this project. Identify other sources you are seeking funds from, and whether those funds are secured. Identify any funds you or your organizations are willing to provide.

The town would like to install eleven benches with engraved plates and trash receptacles and restore the Gazebo/Morrill Bandstand. Thousands of visitors each year enjoy relaxing on the benches at Cole Parkway with our beautiful views of the harbor and ocean. Our residents appreciate the scenic location to relax with generations of family members. Cole Parkway Harborwalk is part of our Scituate Harbor Cultural District designation. We would like to make it a place to be proud of and a destination for tourists. Part of the funding will come from a private purchases of memorial benches and we are asking for CPC funding for the remainder of the project. The DPW will continue to maintain this area by emptying receptacles and facilitating the installation of the benches as they currently do today. The Beautification Commission will continue to plant and care for the gardens as they have in the past.

Proposed Funding

Total Project Cost	CPC Funds Requested	Sources of Funds other than CPA	Amount	Funding Secured? (Y/N)*
\$ 89,981.42	\$ 80,981.42	Private 3 memorial benches	\$ 9,000	Y
			\$	
			\$	
			\$	
			\$	

** If the request is still outstanding, when do you expect to hear a decision?*

OTHER COMMENTS

Provide any other information you think the CPC should be aware of in evaluating your request for funding.

The Town of Scituate will solicit more donations for this project for memorial benches, etc. to help offset the costs.

By signing below, the Applicant represents he/she is duly authorized, agrees to the terms and conditions and all other requirements of this Application and agrees to be bound thereby if funding is granted for the Project.

Date: 12/5/18 Signature: *Ronnie Devin*

FOR COMMUNITY PRESERVATION COMMITTEE USE

This request received by Scituate CPC on _____

Copies provided to CPC Members on _____

Additional information required: _____

Committee Vote

Votes:	Yes / No	Votes: Y/N/Abstain	Date
Recommend to Town Meeting			

Other: _____

**Cole Parkway Harborwalk Morrill Bandstand/Gazebo Benches and Trash Receptacles
Update 20181205**

Benches and Trash Receptacles Purchase, Shipping and Installation

11 Eight foot IPE Bench with Black Cast supports 3 x 12 engraved plaques \$25,960

1 Recycle Container and 5 Trash Receptacles with Dome Tops \$11,465

Freight \$1,745

Installation and concrete preparation bolted down \$15,000

\$54,170 Total Bench & Trash Receptacle Cost

Morrill Bandstand/Gazebo Repairs Estimate – Kevin Kelly Facilities Director

**Foundation & Footings, Frame, Roofing & Ventilation, Siding & Exterior trim,
Electrical and Painting \$28,011.42**

**Electrical Wiring and replace 18 recess lights in ceiling with new led retrofit units
\$2800.00**

**Bring water up to the Gazebo for watering gardens and install storage box for hoses
& gardening tools \$5,000**

\$35,811.42 Estimated cost for rehabilitation of Morrill Bandstand/Gazebo

Total Request \$89,981.42

Lorraine Devin

From: Gail Caruso <GailCaruso@obrienandsons.com>
Sent: Wednesday, October 17, 2018 12:01 PM
To: Lorraine Devin
Cc: Joe Dufour
Subject: RE: Cole Parkway, Scituate, MA

Hi Lorraine,

Yes; you can use the same pricing.

Thank you,

Gail

Gail Caruso
M. E. O'Brien & Sons, Inc.
17 Trotter Drive
P.O. Box 718
Medway, MA 02053
(508) 359-4200, Ext. 114
(800) 835-0056
(508) 533-6342(Fax)
SDO CERTIFIED WBE
www.obrienandsons.com
mailto:Gail_Caruso@obrienandsons.com



PLEASE NOTE OUR NEW ADDRESS

From: Lorraine Devin [mailto:ldevin@scituatema.gov]
Sent: Wednesday, October 17, 2018 11:56 AM
To: Gail Caruso <GailCaruso@obrienandsons.com>; Joe Dufour <JoeDufour@obrienandsons.com>
Subject: RE: Cole Parkway, Scituate, MA

Hi Joe and Gail,

I am submitting this project to our Community Preservation Act Committee and would like to confirm if our quote is still valid and the same pricing. Please let me know if we need to resubmit or if it is okay to use this August quote.

Thank you,

Lorraine



M.E. O'BRIEN & SONS, INC.
93 West Street - P O Box 650 / Medfield MA 02052
508-359-4200 (phone) / 508-359-2817 (fax)
SDO Certified WBE (MA Only)

QUOTATION

Date: August 2, 2018

Page 1 of 3

Job: Cole Parkway

Location: Scituate, MA

Salesman: Joe Dufour, CPSI, Park & Playground Consultant/gmc (Joe_Dufour@obrienandsons.com)

Attention: Lorraine Devin

Tel.:

E-mail: ldevin@scituatema.gov

We are pleased to offer our quotation on the following for the above subject job:

<u>QTY.</u>	<u>MODEL #</u>	<u>DESCRIPTION</u>	<u>TOTAL</u>
11	447-80I	DuMor 8' Long, Ipe Slat Bench with Backrest, 2 Cast Aluminum End Supports and End Armrests, Surface Mount, Black Powder Coat, Each Bench Comes with a 3" x 12" Zinc Etched Plaque factory installed. Verbiage: TBD	\$25,960.00
1	125-31I/ CVR-20-RC-0040	DuMor 31 Gallon Ipe Slat Receptacle with Galvanized Steel Liner and Hardware, 4" Deposit Hole, Dome Top Lid with Vinyl Lettering Saying "Bottles + Cans", Black Powder Coat, Detailed with Star Disks, Surface Mount	\$ 1,890.00
5	152-31I/ CVR-20-PT	DuMor 31 Gallon Ipe Slat Receptacle with Galvanized Steel Liner and Hardware, 22 3/16" Dia. Steel Dome Lid with Push Door, Black Powder Coat, Detailed with Satr Disks, Surface Mount	\$ 9,575.00
		Freight:	\$ 1,745.00
		TOTAL FURNISHED AND DELIVERED:	\$39,170.00



M.E. O'BRIEN & SONS, INC.
93 West Street - P O Box 650 / Medfield MA 02052
508-359-4200 (phone) / 508-359-2817 (fax)
SDO Certified WBE (MA Only)

QUOTATION

Date: August 2, 2018

Page 2 of 3

Job: Cole Parkway

Location: Scituate, MA

Salesman: Joe Dufour, CPSI, Park & Playground Consultant/gmc (Joe_Dufour@obrienandsons.com)

Attention: Lorraine Devlin

Tel.:

E-mail: ldevin@scituatema.gov

Date: _____	Signature of Approval: _____
Printed Name and Title: _____	
Purchase Order #, if applicable _____	
Amount: \$ _____	
Ship to <u>business</u> name _____	
Ship to address _____	
Contact Name _____	Telephone _____
Bill to <u>business</u> name _____	
Bill to address _____	
Contact Name _____	Telephone _____
Need plaque verbiage _____	



M.E. O'BRIEN & SONS, INC.
93 West Street - P O Box 650 / Medfield MA 02052
508-359-4200 (phone) / 508-359-2817 (fax)
SDO Certified WBE (MA Only)

QUOTATION

Date: August 2, 2018 Page 3 of 3
Job: Cole Parkway
Location: Scituate, MA
Salesman: Joe Dufour, CPSI, Park & Playground Consultant/gmc (Joe_Dufour@obrienandsons.com)
Attention: Lorraine Devin
Tel.:
E-mail: ldevin@scituatema.gov

****PLEASE READ – IMPORTANT NOTES – PLEASE READ****

- Contractor/Customer is responsible for quantity, color, and product confirmation.
- Prices based on quantities listed. Any change to quantities may impact prices quoted.
- M.E. O'Brien & Sons is NOT responsible for plan take-offs. All quantities, square footages, thicknesses, etc. are the responsibility of the purchaser. Confirm and double check quantities quoted. It is the responsibility of the purchaser to approve/purchase items "per plan".
- Prices quoted are firm for 30 days only and are subject to review thereafter.
- Prices are for materials only unless otherwise noted.
- Prices do NOT include off-loading, lift-gate (lift-gate is an additional charge) or inside delivery.
- Prices do NOT include sales tax, resilient surfacing, assembly or installation.
- If installation is included, M.E. O'Brien & Sons is NOT responsible for buried underground hazards including, but not limited to: ledge, unsuitable bearing soils, unmarked utilities, boulders, construction debris and any other conditions beyond our control. Additional cost will be required to rectify these situations.
- Prices are not using prevailing wages unless otherwise specified.
- Prices do NOT include cost for electrical cut outs or staining of tongue and groove roof decking unless otherwise noted.
- Standard manufacturer's design, colors, specifications, and construction apply.
- If ordered, inspect entire delivery carefully, making note on delivery receipt of ANY damage so a freight claim can be filed if damage is discovered after opening package(s).
- Retainage does not apply.
- Returns must be made within 30 calendar days of receipt of order. Customer is responsible for re-stocking fee plus shipping charges (to and from) for all returned items.
- Allow 7 to 9 weeks for delivery of materials after receipt of order and architectural approval, if required.

If we can be of further assistance please do not hesitate to contact us. Thank you!



RebuildEx of Plymouth County LLC

6 Commerce Way Carver MA, 02330

888-732-8453

Proposal

For:

Scituate Gazebo/Bandstand

As per attached Plans

Plans and permits:

All plans and permits necessary to complete this project are included.

Note: All RebuildEx LLC. plans are copyright protected and cannot be

reproduced or used by other parties for any purpose.

Foundation & Footings:

Footings to be installed in line with building codes on proposed deck on the side of the gazebo.

Frame:

Framing for new deck to in line with new building codes, Deck to be 140 SQ. FT. and to be added as the attached diagram shows. New deck to be level with gazebo and to have stairs on all three open sides. All framing to be done with pressure treated wood. Gazebo, stairs and new deck decking to be Trex Select. (Color to be determined)

Roofing & Ventilation:

Remove existing wood roof shingles and replace with Timberline HD GAF Asphalt shingles. All roof work to be done to code.

Siding & Exterior trim:

Install 1"x4" pvc trim boards vertically along the outside of handicap ramp. Replace any rotted trim.

Electrical:

Replace all recessed light with new L.E.D recessed lights.

Painting:

Prep, sand and fill as needed. Prime and paint all trim, railing, posts and ceiling.

Grand Total

\$28,011.42

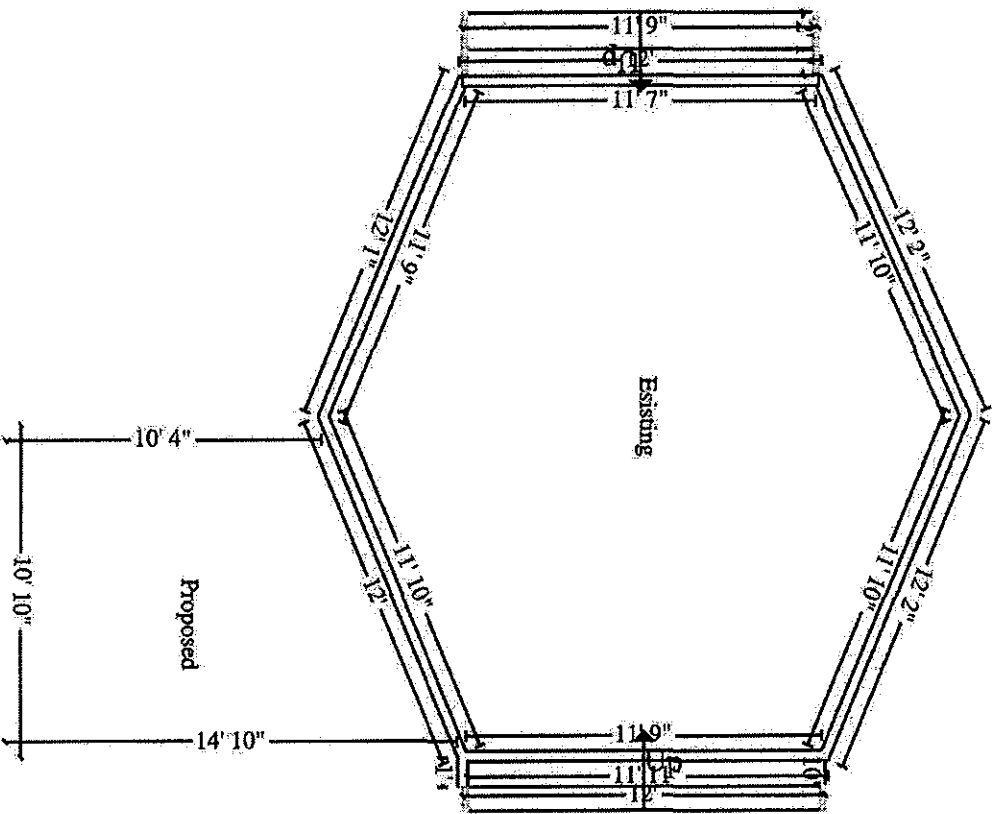

WOOD ELECTRIC COMP. INC.

P.O. BOX 8
NORTH SCITUATE, MA 02060

ESTIMATE

Date	QUOTE#
11/5/2018	613

Name / Address

TOWN OF SCITUATE
PUBLIC GROUNDS
SCITUATE,MA 02066
ATTN: KEVIN KELLY

Description			Qty	Total
erplace 18 recess lights in ceiling with new led retrofit units.			1	2,800.00
Phone #	Fax #	E-mail	Total \$2,800.00	
1-781-545-6938	1-781-545-0235	WELECTRICC@COMCAST.NET		
CUSTOMER Signature				

Town of Scituate

RECREATION COMMISSION
FRIENDS OF SCITUATE RECREATION, INC.

600 Chief Justice Cushing Hwy.
Scituate, Massachusetts 02066
TEL: (781) 545-8738
FAX: (781) 545-6990



Gary Myerson, Chairperson
C/o: Community Preservation Committee
600 Chief Justice Cushing Highway
Scituate, MA 02066

RE: Morrell Bandstand Restoration Project in Cole Parkway

December 5, 2018

Dear Gary,

On behalf of the Recreation Commission, I am writing this letter to support the proposed Morrell Bandstand Restoration project located in Cole Parkway.

The Recreation Commission unanimously to support this project.

Our Commission supports projects that promote both passive and active recreation as well as, help fulfill the Open Space & Recreation goals of the Town's Master Plan and this initiative does this and more.

Sincerely,

Jennifer McMellen,
Chairman

cc: Recreation Commission